

USE APPROPRIATE TERMINATION

- RUBBERGARD EPDM MEMBRANE
- APPROPRIATE FASTENERS
4" (101.6 mm) O.C. MAX
- WELDED METAL SCUPPER SLEEVE
(SEE NOTE #5)
- CONTINUOUS BEAD OF ELEVATE WATER BLOCK
(SEE NOTE #2)

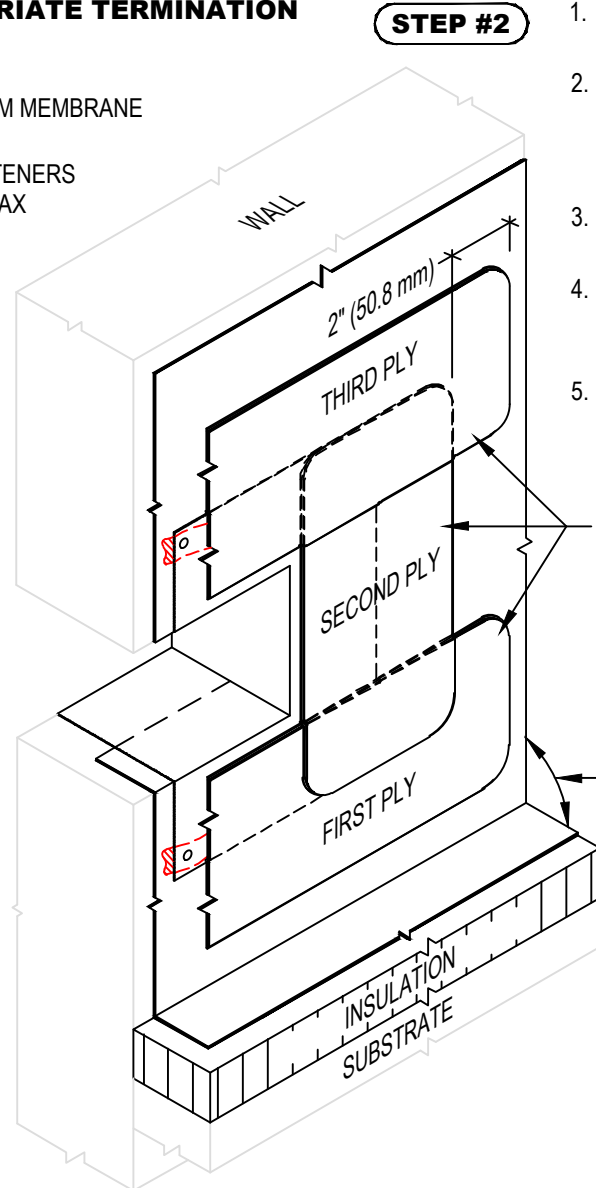

NOTE:

1. REFER TO THE ELEVATE™ WEBSITE FOR MOST CURRENT INFORMATION.
2. STEP #1 - APPLY CONTINUOUS BEAD OF ELEVATE WATER BLOCK, CENTERED UNDER FASTENERS. SECURE SCUPPER METAL WITH APPROPRIATE FASTENERS.
3. STEP #2 - STRIP IN ALL EXPOSED EDGES OF SCUPPER AS INDICATED WITH 5" (127 mm) QUICKSEAM FLASHING.
4. USE ACCEPTABLE ELEVATE PRIMER TO CLEAN AND PRIME MATING SURFACES PRIOR TO INSTALLATION OF QUICKSEAM PRODUCTS.
5. SCUPPER MUST BE WELDED METAL SLEEVE WITH 3" (76.2 mm) FLANGE AND ROUNDED CORNERS.

5" (127 mm) QUICKSEAM FLASHING
CENTERED OVER EDGE OF METAL FLANGE
(SEE NOTE #3)

**USE APPROPRIATE
BASE TIE-IN DETAIL**

WARRANTY MEMBRANE REQUIREMENTS:
UP TO 15-YEAR: 45 MIL
UP TO 25-YEAR: 60 MIL