

PVC SKIRTED DRIP EDGE FASCIA

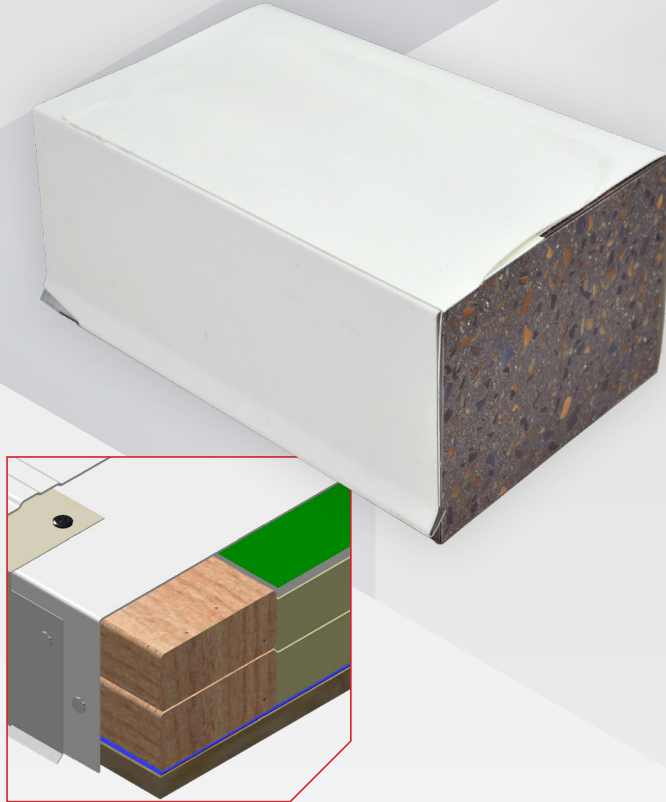

PRODUCT DESCRIPTION

Elevate PVC Skirted Drip Edge Fascia is engineered for seamless integration with PVC-coated membranes, providing an architectural, visually attractive termination to divert water flow off the roof assembly.

FEATURES

- Available in 2 to 8-inch face size and 10-foot lengths.
- Fabricated from vinyl-coated metal with an attached 6-inch membrane skirt.
- Profiles can be custom-fabricated to meet most specifications.
- Can be fabricated to accommodate various roof pitches and mansards.
- Available in an array of colors including white, tan, gray, dark gray, and also available in a variety of other colors.

CODES & STANDARDS



ANSI/SPRI/FM4435/ES-1

INSTALLATION

- 1] A wood nailer is required if 1-inch or greater of insulation is used. The wood nailer should be attached in accordance with ANSI/SPRI/FM4435/ES-1.
- 2] Install in accordance with Elevate Detail 3120.
- 3] For any deviation from the requirements set forth in detail drawings, please contact your Regional Technical Coordinator at (800) 428-4511.

MATERIAL	THICKNESS	FINISH
Aluminum	0.040 in.	Membrane
Stainless Steel	24 gauge	Membrane
Galvanized	24 gauge	Membrane

Talk to your Elevate rep or visit
HolcimElevate.com to learn more.



FIND YOUR REP