

EDGE GARD COMPRESSION FASCIA

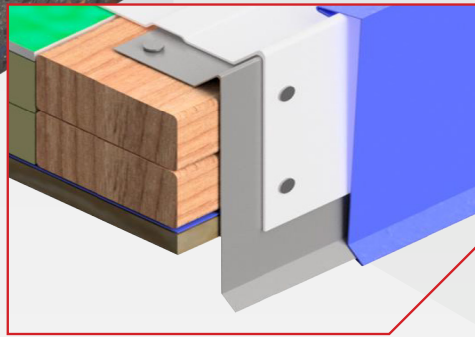
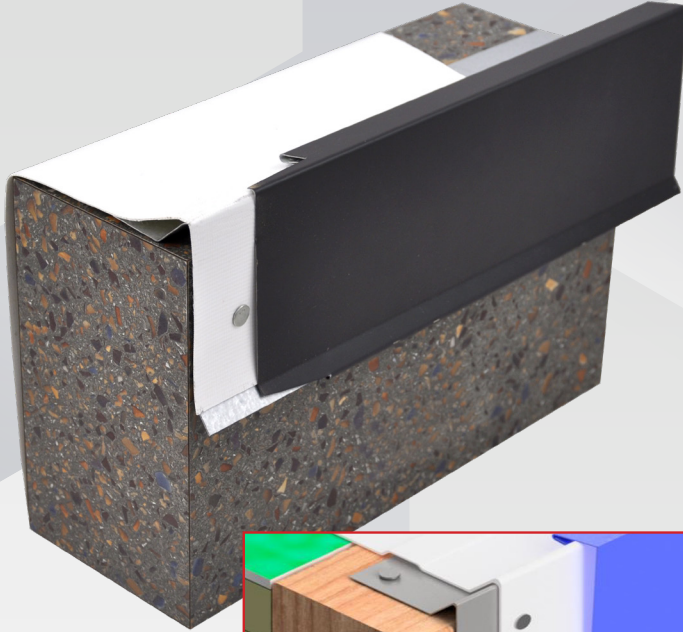

| MATERIAL | THICKNESS | FINISH |
|------------------|-----------|--------------|
| Aluminum | 0.040 in. | Mill or PVDF |
| Stainless Steel | 24 gauge | N/A |
| Bonderized Steel | 24 gauge | N/A |
| Galvalume® | 24 gauge | Mill or PVDF |
| Copper | 16 oz. | Mill |

PRODUCT DESCRIPTION

Elevate EdgeGuard Compression Fascia offers robust perimeter protection for single-ply roofing systems and delivers a sleek, metal edge appearance. Designed for quick installation without the need for perimeter welding or sealants, this system provides both durability and efficiency.

FEATURES

- Available in 3 to 8-inch face size with base and cover made in 10-foot lengths.
- Cover is double-hemmed to prevent friction with the roof material.
- Also available in a flat face profile.
- Ready-to-assemble inside and outside corners are available in the standard and flat face profiles.

CODES & STANDARDS



ANSI/SPRI/FM4435/ES-1

INSTALLATION

- 1] A wood nailer is required if 1-inch or greater of insulation is used. The wood nailer should be attached in accordance with ANSI/SPRI/FM4435/ES-1.
- 2] Install in accordance with Elevate Detail 3110.
- 3] For any deviation from the requirements set forth in detail drawings, please contact your Regional Technical Coordinator at (800) 428-4511.

Talk to your Elevate rep or visit HolcimElevate.com to learn more.



FIND YOUR REP